

Kit Includes:

- Laser cut engraved basswood brick foundation walls.
- Laser cut framing and supports.
- Laser cut windows, door and glazing.
- Laser cut building foundation.
- Interior bracing.
- Kit assembly instructions.



Kit: O-3019

© 2023

Inter-Action Hobbies

www.interactionhobbies.com



1:48 **O Scale**

Victorian Conservatory



- High quality O scale building:
4.0" wide by 2.5" long by 3.1" high
- Assembly & painting required
- Paint, glue, and hobby tools required for assembly are not included
- Greenhouse interior details sold separately

**WARNING: CHOKING HAZARD - Small and sharp parts
Not for young children**

www.interactionhobbies.com

Kit: O-3019

© 2023

Inter-Action Hobbies

The Victorian Conservatory in O Scale (1:48)

Ever wanted that lovely little conservatory in your backyard or maybe a small greenhouse behind the shop where you grow flowers and shrubs to sell to your patrons? This little Victorian style masterpiece is just right for adding just about anywhere as it is compact, but is stunning in appearance for an up close location on the layout. Add a few chairs and tables for a tea party, or fill it with plants and gardening stuff that comes with our additional Greenhouse Interior Detail kit. It will for sure be an attention getter.

Main Kit Components:

- 3 sheets of laser cut and engraved stabilized resin impregnated board (RIB)
- 2 sheet of laser cut basswood
- 1 sheet laser cut clear window glazing
- 1 sheet laser cut matt board
- Kit assembly instructions and parts ID sheet

Suggested Tools and Supplies:

- ***Especially for this kit, we recommend obtaining some Liquid Pressure Sensitive Adhesive such as that available from MicroMark Tools Part# 84775.***
- X-Acto type knife with fresh blades (#11 style is best). Change your blades often for better results.
- Tweezers.
- Fine sandpaper (300+ Grit) and / or emery boards.
- Masking tape or clear adhesive tape.
- Canopy Glue, Probond, Elmers or other PVA white glue or Scotch Quick-Dry Adhesive (I like the Scotch adhesive as it dries with little residue).
- Scotch Clear Glue with 2-Way Applicator.
- CA glue for bonding of small hard to place parts. For immediate bonding of small parts, use a 1:1 blend of Slo-Zap CA and canopy glue (But you have to work fast!).
- Acrylic model paint or craft paints. I recommend investing in the higher quality Vallejo and MIG by Ammo products as they have superior coverage and stronger pigments.

We hope you enjoy making this kit as much as we did providing it to you. If you have any questions, please contact us at sales@inter-action.ca.

NOTE: If you would like to view these instructions in full colour, please feel free to download a full colour copy at www.interactionhobbies.com and click on the link for "Instructions" near the top of the page.

The following instructions and photos will provide the basics for assembling this detailed kit. We have tried to make the steps as straight forward as possible, but please note that you might want to change the order of assembly to suit your own technique and modifications that you might make along the way. As usual, it is best to familiarize yourself with all the parts and instructions before you start on this craftsman level kit.

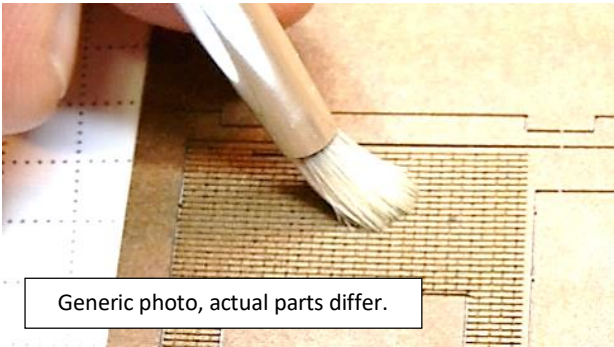

Start by cleaning out any contaminants and remaining dust that may be in the cracks of the engraved details in sign, walls etc.

This is done by using a stiff bristle brush and gently dusting the nooks and crannies. Avoid touching very fine details like window mullions etc.

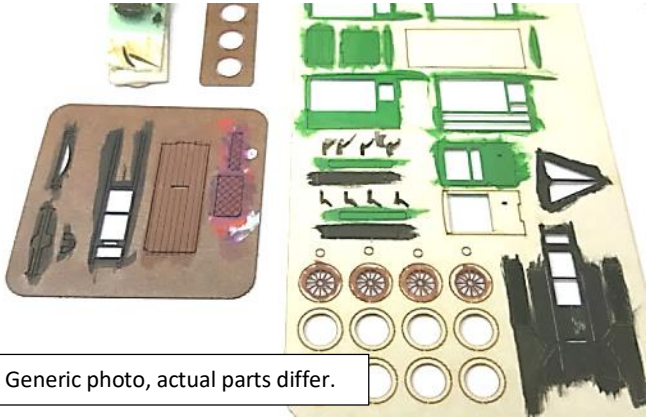

I like to paint some of the parts while still in the carrier. Some parts may need to be painted on the backside as well. Some touch up will be required after assembly, but this is a good start.

Always use your X-ACTO knife in such a way that when you cut a piece off of the sprue, the knife blade runs off away from the piece and not digging into the part.

After removal from the carrier, some touch up of edges that will be visible should be done before assembly; and, some touch up may be required after assembly

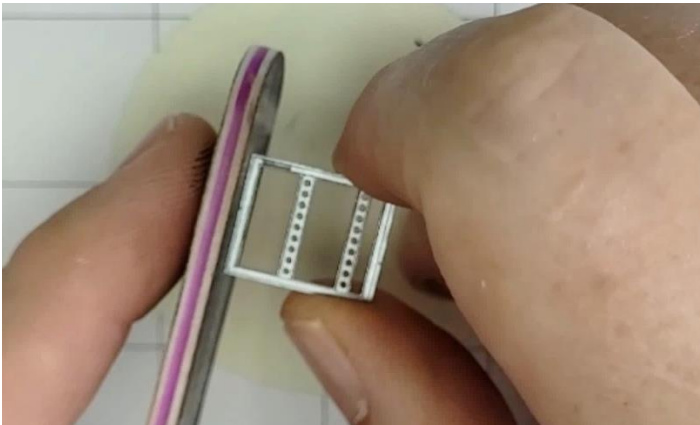

When removing pieces from carrier sheets, run your fingers down the cut off tabs and if you can feel them, sand them off lightly for a better fit. An emery board / disposable nail file is ideal for this purpose.

For a very helpful instructional video on building this kit, please see our YouTube channel.

Go to www.youtube.com and search for InterAction Hobbies. Look for our channel and click on it. Then click on "Videos" and look for the video titled "The Conservatory - Greenhouse in O Scale".

Or scan the QR code below to go to the video link;



The video shows the O scale build of this kit, but it will still be very helpful to watch for the other scales of this conservatory kit.



A handy glue applicator to use when laminating larger panels like the interior wall/stringer panels, is "Scotch Clear Glue, with 2-Way Applicator". This glue bottle has a "pad" that you can dab glue onto larger areas for better coverage. I work over a clean paper towel for dabbing the backside of each part.



Generic photo, actual parts differ.

3D parts are included in the optional detail kits. If you have an optional detail kit, please read this for tips on painting and removing the 3D parts.

Painting 3D parts are easier while still on the supports. Stick the parts and carrier on some double sided tape and to a popsicle stick or scrap piece of wood.

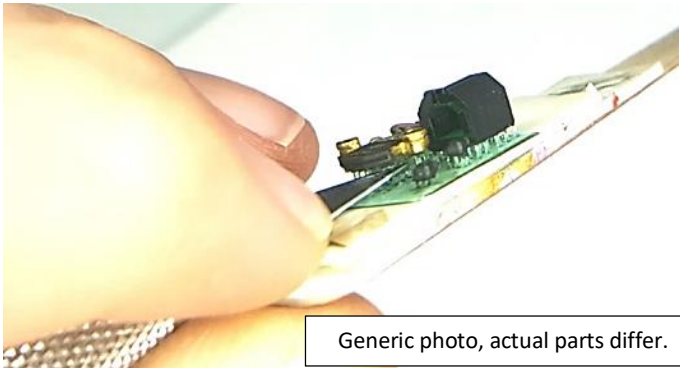

Generic photo, actual parts differ.

3D printed parts removal with an x-acto blade or fine sprue cutter. **GO SLOW, ONE PIN AT A TIME!**

Paint / Colors used in prototype model:

Foundation Walls	Mortar Joints 1. Vallejo Model Color Off-White 70.820
Framework, trim, finials, posts	Vallejo Model Color Aluminum 71.062 Or Vallejo Model Color White 70.951
Vent Windows	Vallejo Model Color Aluminum 71.062 Or Vallejo Model Color White 70.951

Foundation Walls	Bricks 1. Vallejo Model Color Flat Red 70.957 2. Vallejo Game Color Bloody Red 72.010
Foundation	Vallejo Game Color Stonewall Grey 72.049 (drybrush with off white)





Start by painting the concrete foundation 1 and add any aging that you would like to do.



Paint the brick foundation walls white, making sure you get paint into all the mortar joints. Then, using a firm makeup sponge moist with red paint (no excess paint on the sponge), make light strokes at a 45 degree angle to the mortar joints to just get paint on the surface of the individual bricks without filling the engraved mortar joints.



Bevel the ends of the wall panels to at least 45 degrees, so that it comes to a sharp edge without removing any material from the front face of the wall panel.

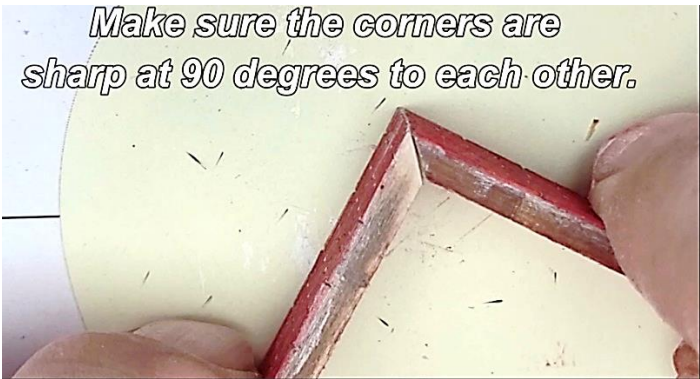

Make sure the corners are sharp at 90 degrees to each other.

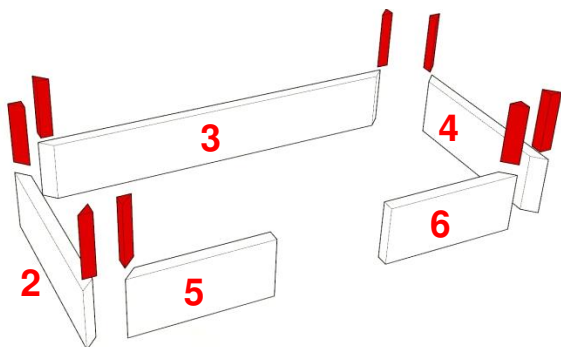

These are the corners you will need to taper to at least a 45 degree angle.

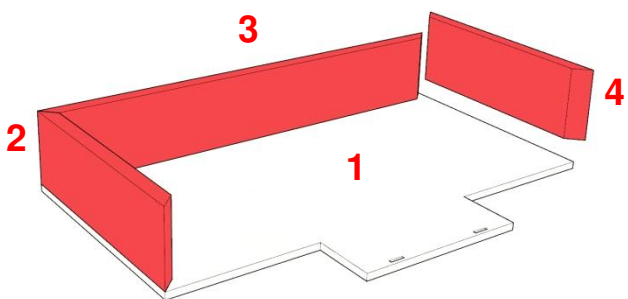

Glue panels 2 and 3 flush to the edge of foundation 1. Then glue panel 4 in place. Then glue panels 5 and 6 in place.

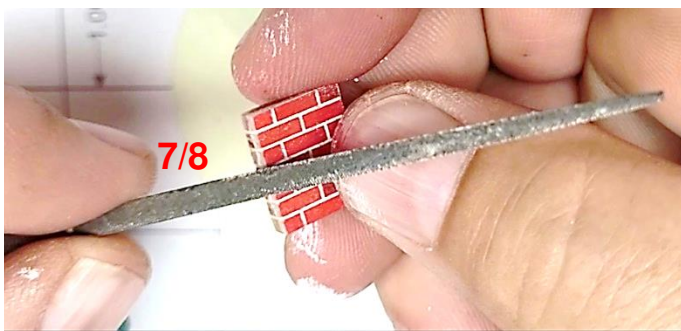

File a mortar joint into the end face of panels 7 and 8.

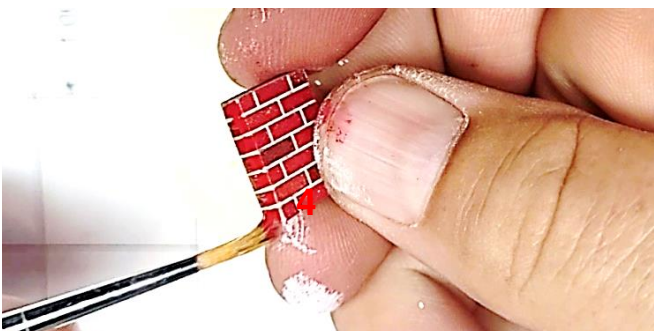

Don't forget to paint those end bricks.

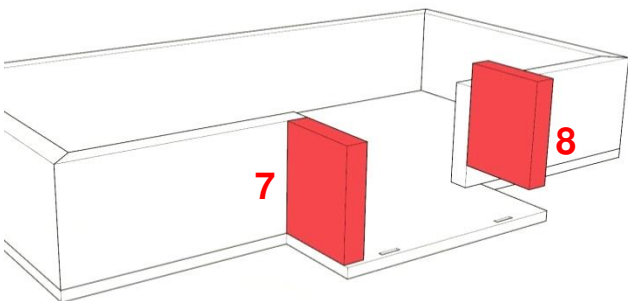

Glue panels 7 and 8 in place.

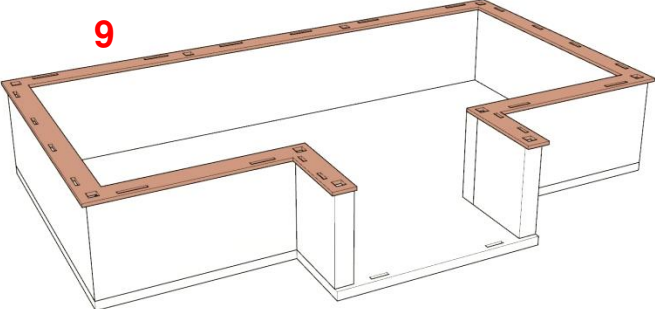

Glue the foundation cap 9 in place. It should sit so that the inside edge of 9 is flush with the inside edges of the foundation wall, all the way around.

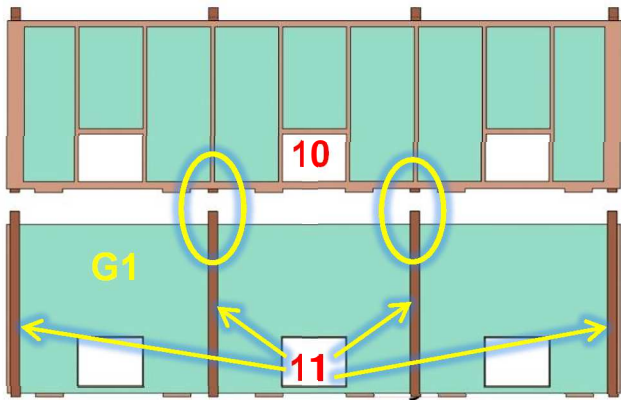

Posts to be flush with bottom of tabs.

Glue glazing G1 to the inside face of panel 10. Then glue two of posts 11 so they are centered on the vertical mullions of panel 10.

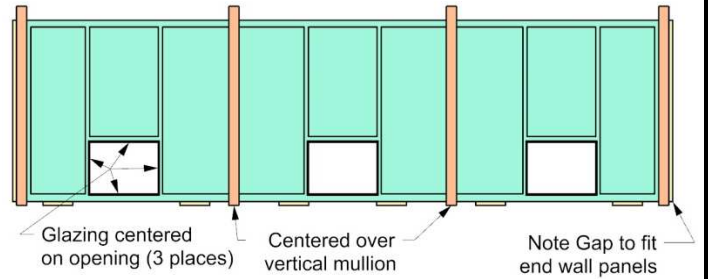

The posts should be flush with the bottom of the tabs on panel 10. Glue post 11 to the outer edges of panel 10 so that panel 12 can nest against post 11 and tight to the edge of panel 10.

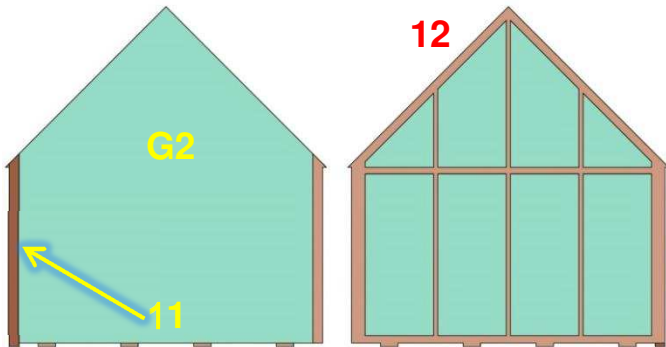

Flush with bottom edge of tabs.
1/16" corner post. Front corners only.

Glue glazing G2 to end wall panel 12. Glue post 11 flush with the bottom of the tabs and outer edge of 12.

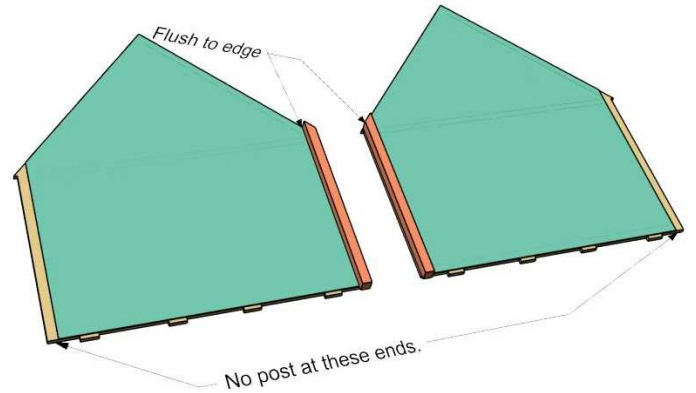

Make sure the opposite end wall will be a mirror image.

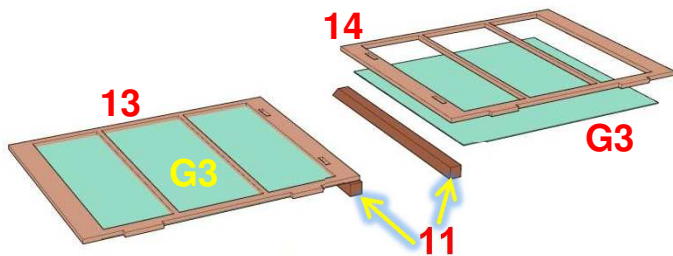

Glue glazing G3, centered left and right to panels 13 and 14.

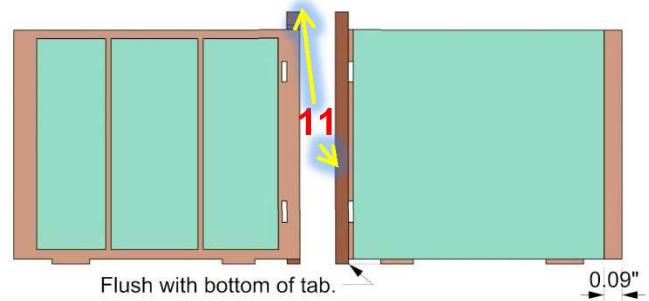

Glue posts 11 flush to the tabs and edge of panels 13 and 14.

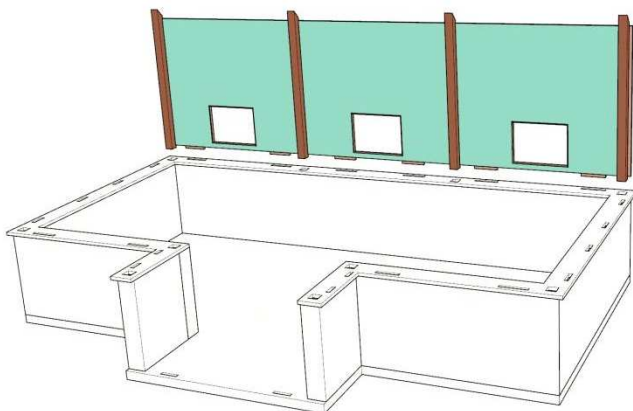

Glue the back wall to the foundation, inserting the tabs on 10 into the slots in the foundation cap.

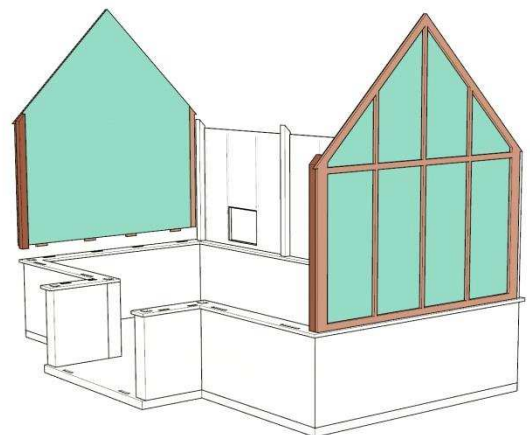

Glue the end walls in place.

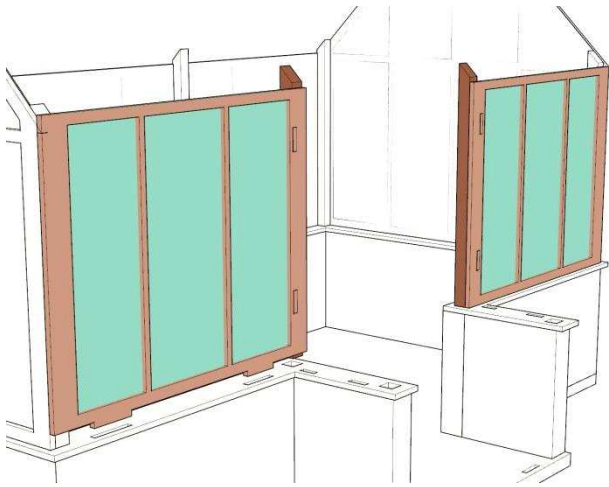

Glue the front wall panels in place.

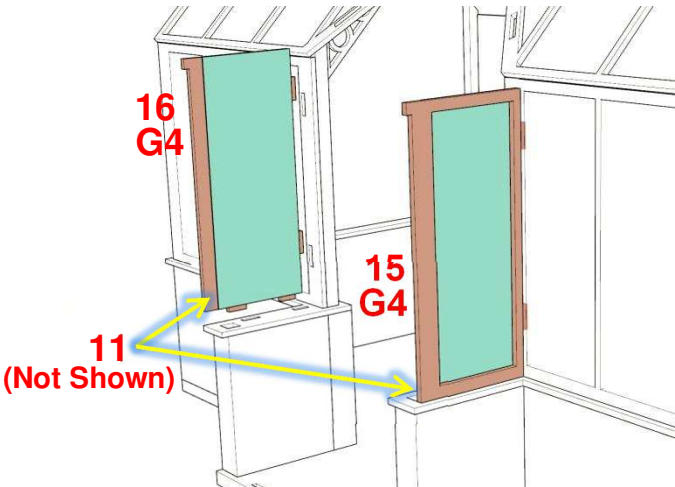

Glue Glazing G4 to entry window panels 15 and 16 so the glazing is flush to the edge of the panels as shown.

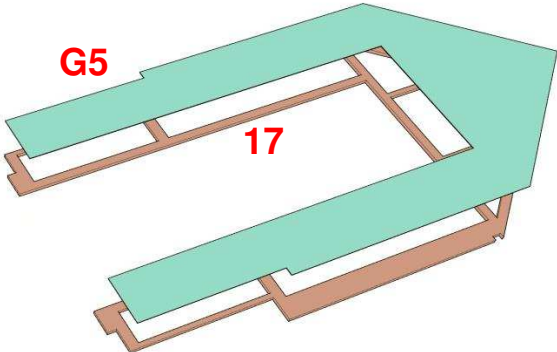

Glue glazing G5 to the inside face of panel 17.

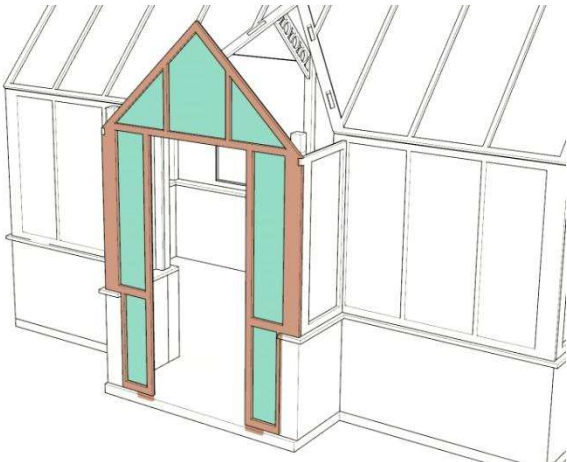

Glue in place into the tabs in the foundation and the tabs on the entry window panels.

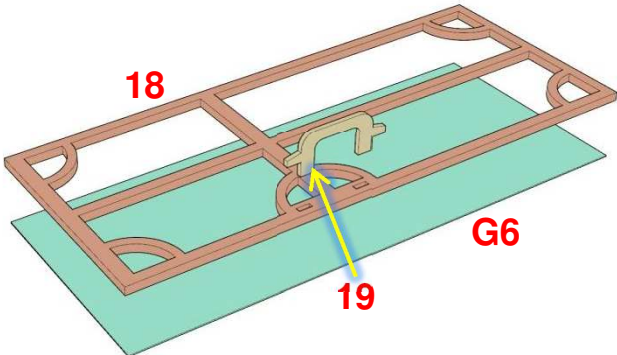

Glue glazing G6 to door 18. Glue handle into the slots in the door.

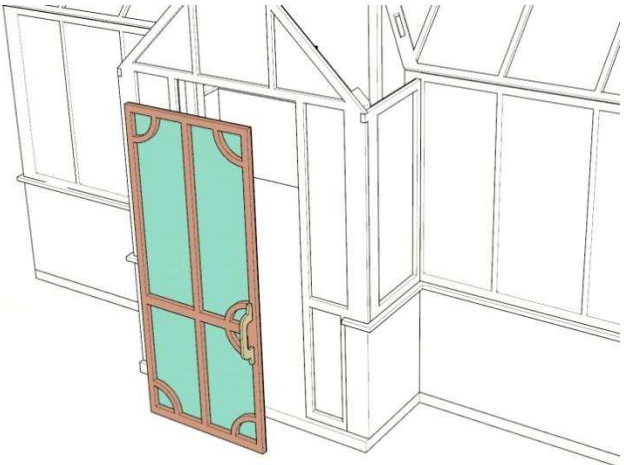

Glue door in place in either a closed or open position.



If you have the Greenhouse Detail Kit, now would be the time to assemble and install it or any other interior details that you want to add before you put the roof on.

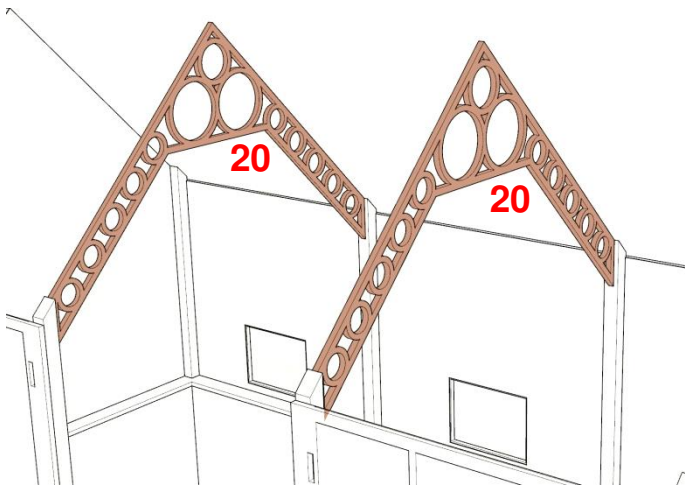

Glue the roof trusses 20 in place.

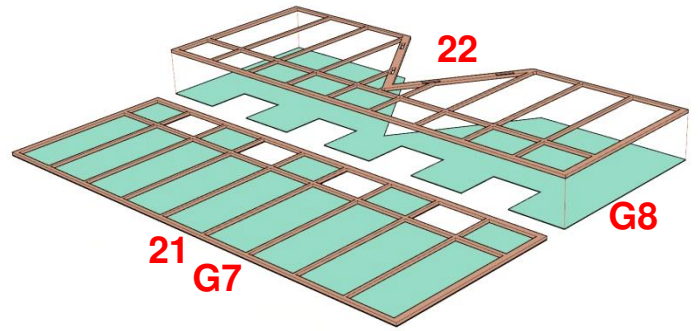

Glue glazing panels G7 and G8 to the roof panels 21 and 22.

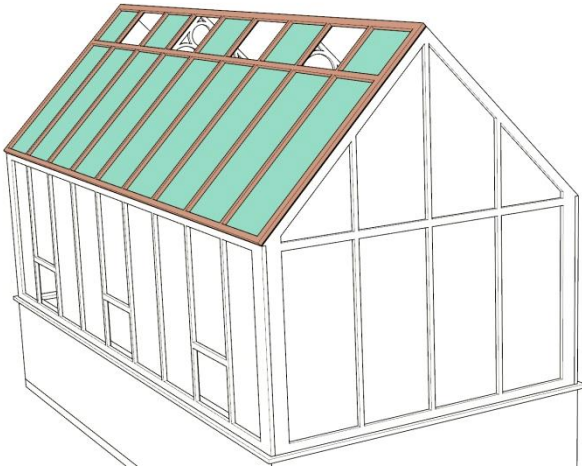

Glue the rear roof panel in place, and then glue the front panel in place.

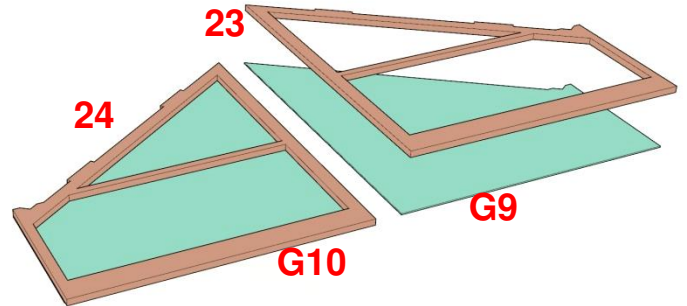

Glue glazing panels G9 to panel 23 and G10 to 24.

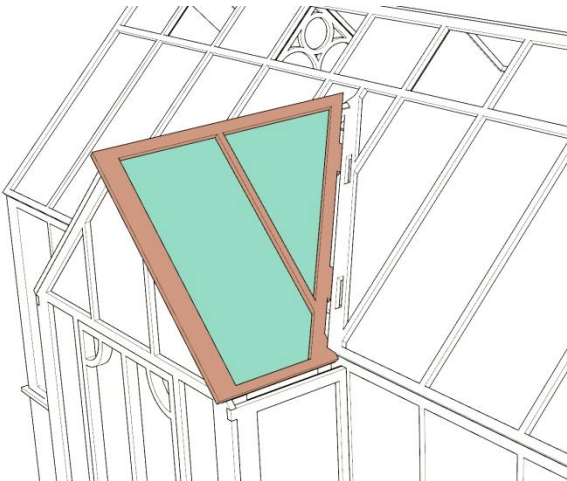

Glue the entry roof panel into the slot in the front roof panel.

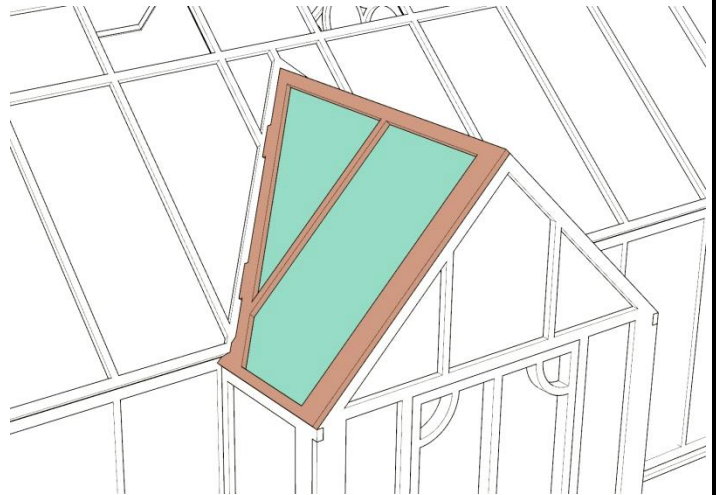

Do the same for the opposite entry roof panel assembly.

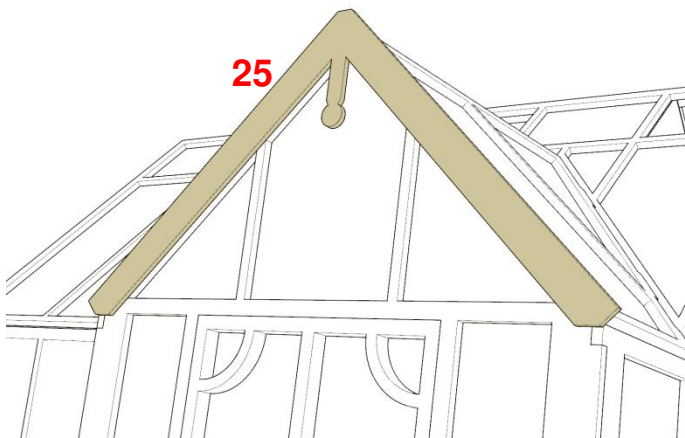

Glue entry trim in place.

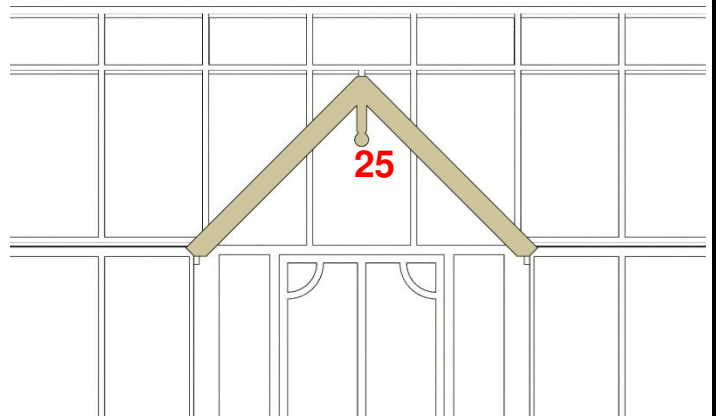

Note positioning of the trim.

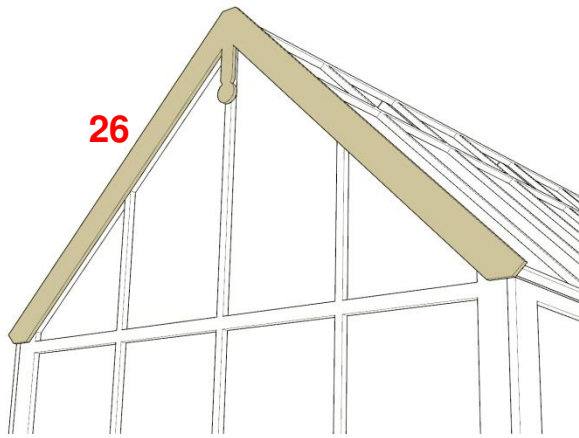

Glue end wall trim in place.

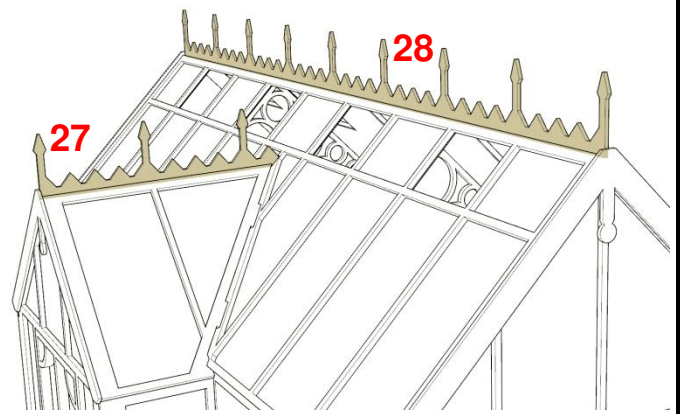

Glue the finials to the ridge of the main roof and entryway roof panels.

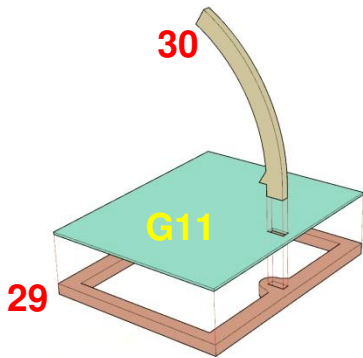

Glue glazing G11 to vent window frame 29. Glue support arm 30 into the slots in G11 and 29 (11 windows needed).

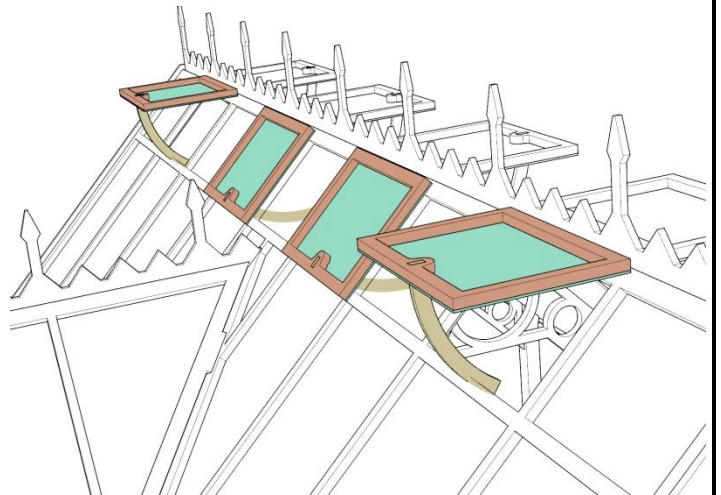

Glue the vent windows in place on the roof in either an open or closed position.

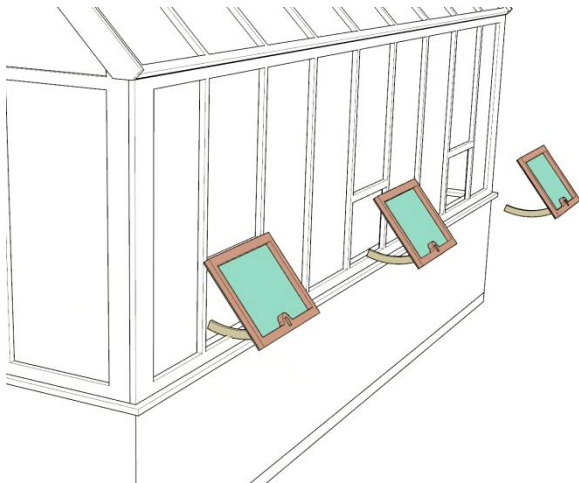

Glue the vent windows into position on the back wall of the building.



Thanks for building this bit of Summer fun. Hope you enjoyed it and see you next time!