



Kit: HO-7515

© 2023
Inter-Action Hobbies

www.interactionhobbies.com



INTER-ACTION
Hobbies

Rail and Tie Craftsman Kits

1:87 HO Scale

Giordano's Delivery Van



- High quality HO scale vehicle:
1.1" wide by 3.1" long by 1.6" high
- Assembly & painting required
- Paint, glue, and hobby tools required for assembly are not included

WARNING: CHOKING HAZARD - Small and sharp parts
Not for young children

www.interactionhobbies.com

Kit: HO-7515

© 2023
Inter-Action Hobbies

Delivery Van in HO Scale (1:87)

This model kit of a step van that you would typically see for deliveries to homes and businesses across North America.

Supplied Kit Components:

- 5 sheets of laser cut and engraved stabilized Resin Impregnated Board (RIB)
- 1 sheet of laser cut clear window glazing
- 1 sheet of laser cut basswood
- 2 pieces of strip wood bracing
- 1 piece of wire
- 1 sheet of waterslide decals
- 3D printed parts on carrier (some parts are very small and may fall off the carrier so take caution not to lose anything when you open the 3D parts box)
- Kit assembly instructions
- Parts diagram
- Mirror bending template

Suggested Tools and Supplies:

- X-Acto type knife with fresh blades (#11 style is recommended)
- Good quality pointed tweezers
- Fine sandpaper (400+ Grit) and/or nail file
- Masking tape or clear adhesive tape
- Probond, Elmers white glue or Scotch Quick-Dry Adhesive (I like the Scotch adhesive as it dries with little residue and has a great fine applicator tip)
- CA glue for immediate bond of small, hard to place parts
- Model Putty or Automotive Spot Putty (3M Bondo Glazing and Spot Putty is my favorite)
- Acrylic or enamel paint

We hope you enjoy making this kit as much as we did providing it to you. If you have any questions, please contact us at sales@inter-action.ca.

The following instructions and photos will provide the basics for assembling this detailed kit. We have tried to make the steps as straight forward as possible, but please note that you might want to change the order of assembly to suit your own technique and modifications that you might make along the way. As usual it is best to familiarize yourself with all the parts and instructions before you start on this craftsman level kit.

NOTE: If you would like to view these instructions in full colour, please feel free to download a full colour copy at www.interactionhobbies.com and click on the link for "Instructions" near the top of the page.

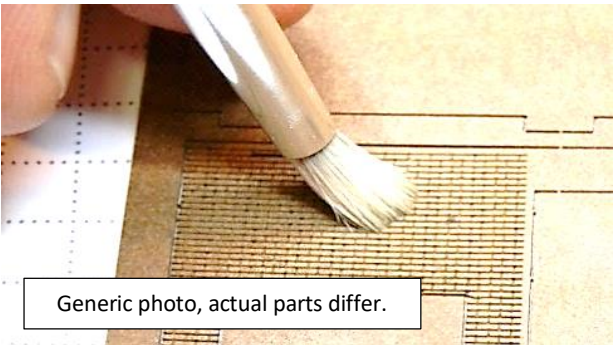

Start by cleaning out any contaminates and remaining dust that may be in the cracks of the engraved details in sign, walls etc.

This is done by using a stiff bristle brush and gently dusting the nooks and crannies. Don't be too aggressive as the material can be brittle and fine detail may be broken or removed. Avoid touching very fine details like window muttons etc.

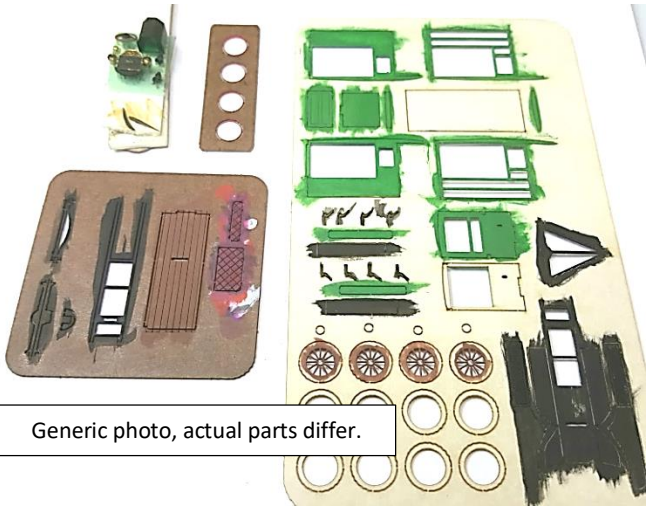

I like to paint the parts while still in the carrier. Some parts may need to be painted on the backside as well. Some touch up will be required after assembly, but this is a good start. You may not want to pre-paint really tiny parts as they may get "glued" to the carrier sheet and will be difficult to remove.

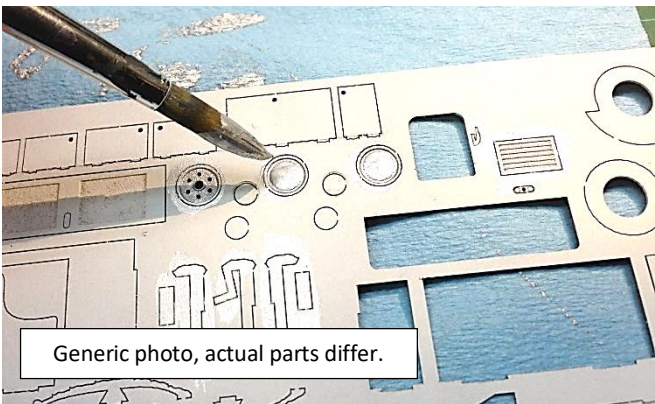

Make sure you consider which side is out or in so you can color the inside and outside or left/right where required.

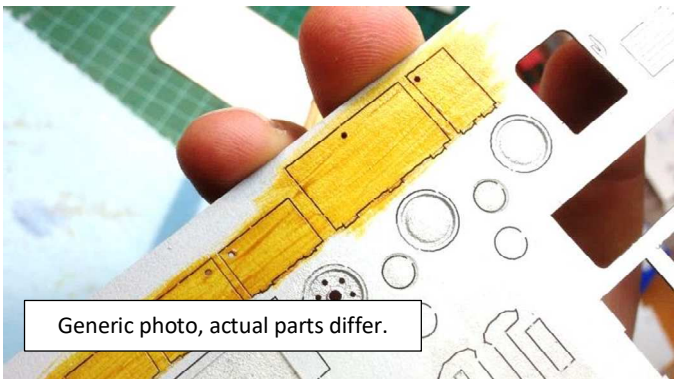

Also for a wood type effect on the cupboards, tables etc, consider using a transparent paint and applying in a streaking effect. I used acrylic paint mixed with some Mod Podge to get this affect above.



Painting the 3D parts are easier while still on the supports. I stick the parts and carrier on some double sided tape and to a popsicle stick or scrap piece of wood.

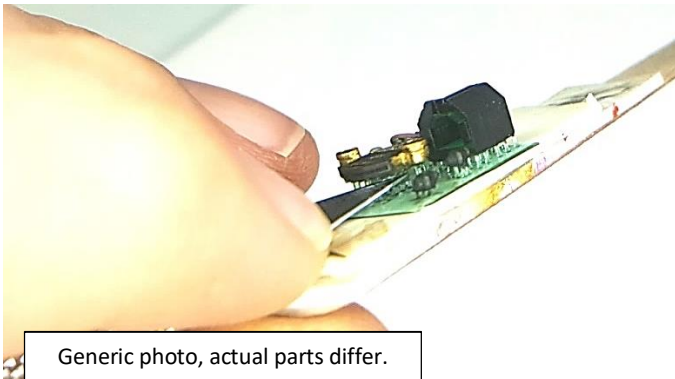

3D printed parts removal with an x-acto blade.
GO SLOW, ONE PIN AT A TIME!

NOTE: In the following instructions you will see some missing sequential part numbers. This is due to other versions of this model that have parts that are not applicable to this model kit.

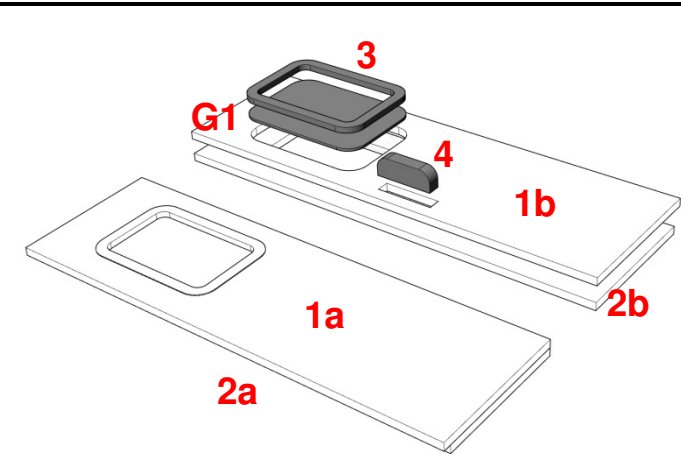

If you want to model the back doors open, remove them from wall panels 1 and 2. Glue the door panels 1a and 1b over top of 2a and 2b. Make sure they align towards the inside edge of the doors. Glue glazing G1 and then window frame 3 in place in each door panel.

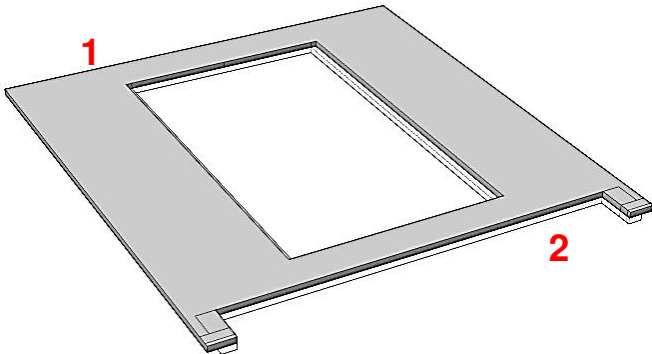

Glue handle 4 into door panel 1b
Glue back wall 1 centered over wall 2.

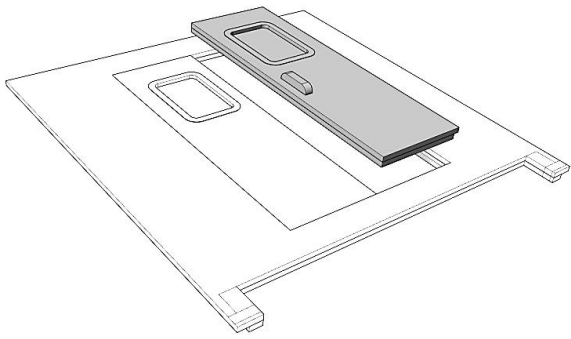

If removed for assembly, the door panels can now be glued in place.

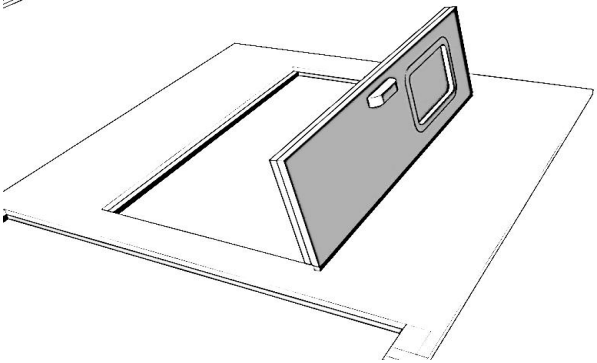

For an open door, glue in place as shown.

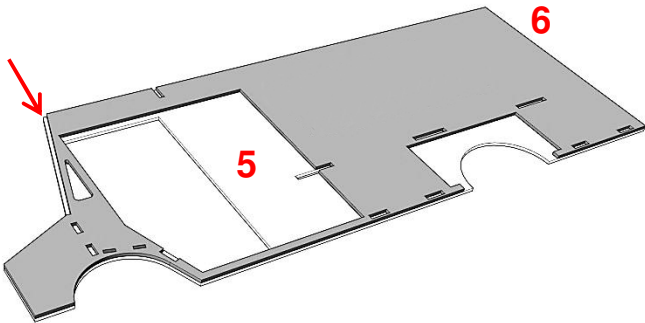

Glue the right hand wall doubler 6 over wall 5. It should be flush all around except the front windshield area.

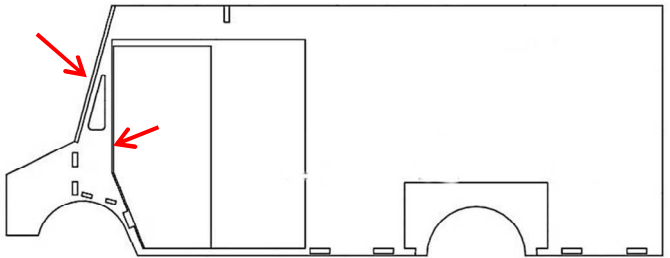

Showing the gap in the aligned wall parts.

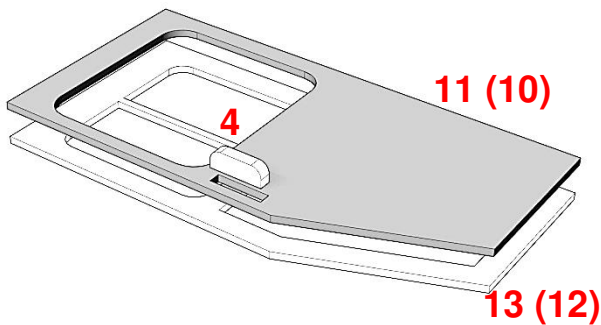

Glue left and right door panels 10 and 11 over top of doublers 12 and 13. Glue door handle 4 on to each of the door panels.

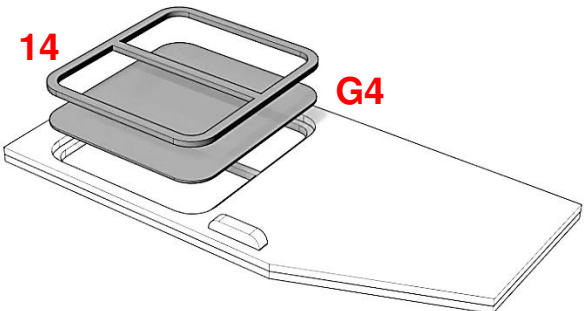

Add a small amount of glue to the window frame opening and set glazing G4 in place. Holding window frame 14 with tweezers, dab into slightly thinned white glue, blot off excess into a paper and set the frame in place over the glazing.

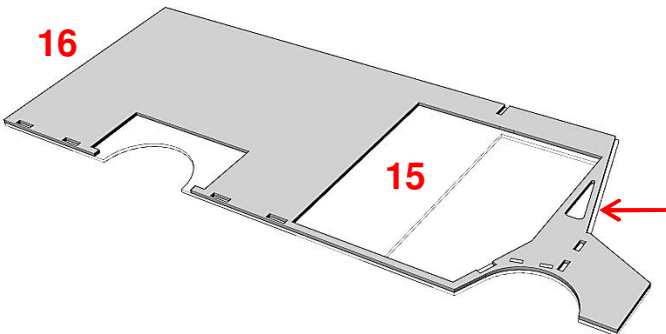

Glue the driver's side wall doubler 16 over wall 15. It should be flush all around except the front windshield area.

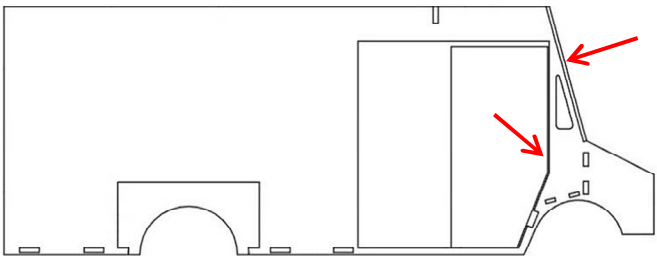

Showing the gap in the aligned wall parts.

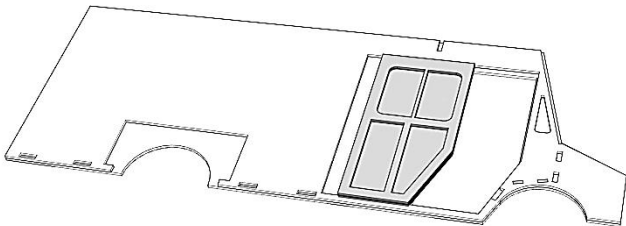

Decide if the doors will be in the open or closed position and glue in place in opening.

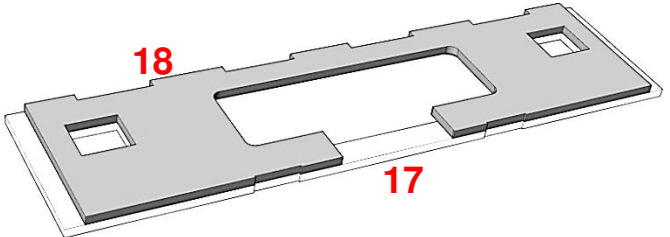

Glue front cowl doubler 18 behind cowl wall 17. It should be centered and flush to the bottom of 18.

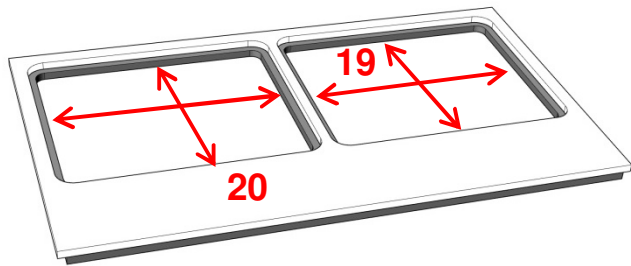

Glue windshield panel 20 over top of doubler 19 so that it is centered on the windshield opening all around.

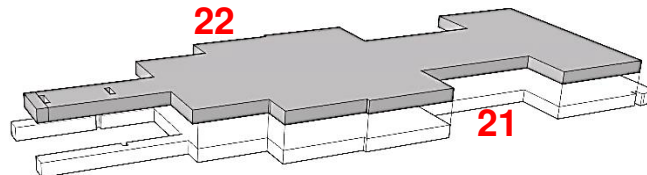

Glue chassis 22 over top of chassis panel 21. Note alignment above.

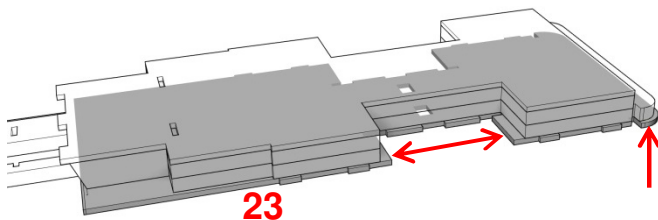

Glue chassis pan 23 to the bottom of panel 21, centered on the wheel well opening. Note the even rear bumper alignment.

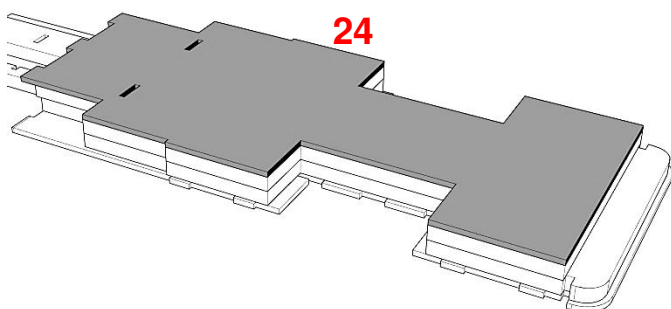
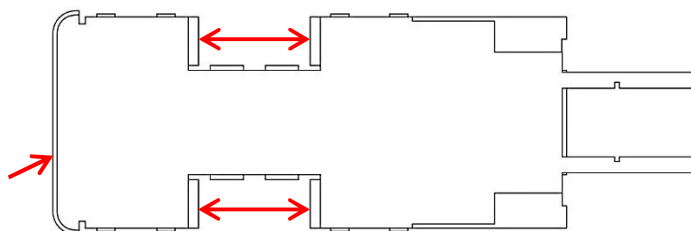

Glue the floor 24 over top of the chassis assembly. It should be flush to the wheel wells all around. It will overhang the front as shown to the right.

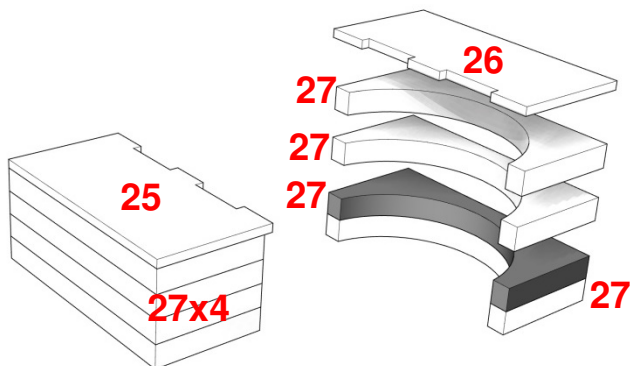
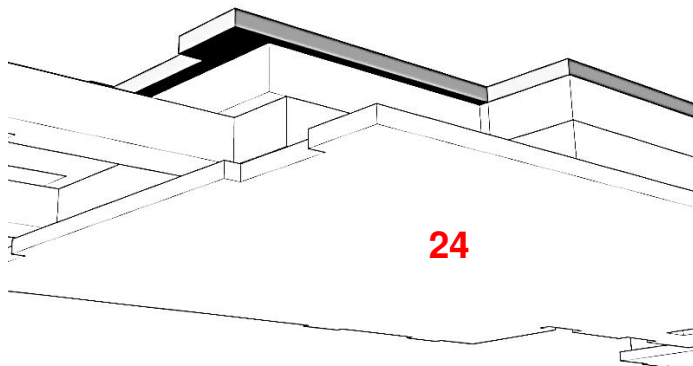

Layer wheel well parts 27 together (x4) as shown. Glue 25 flush on 3 sides with the wheel well assembly. Repeat for the right hand side with 26.

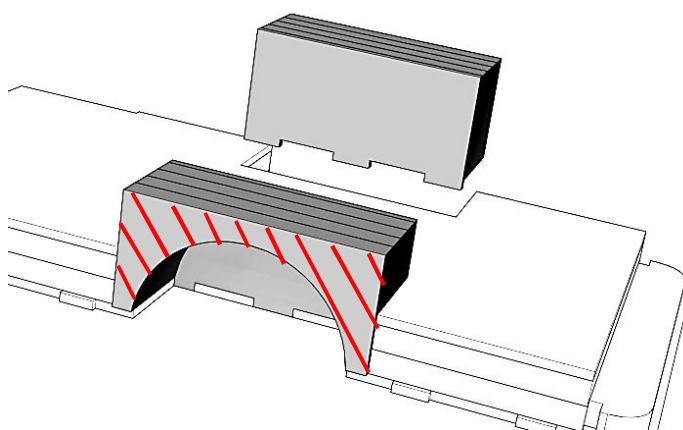

You will need to sand the outboard face of the wheel well assemblies so that it sits proud of the outboard chassis face by the thickness of the wall doubler 5 and 15.

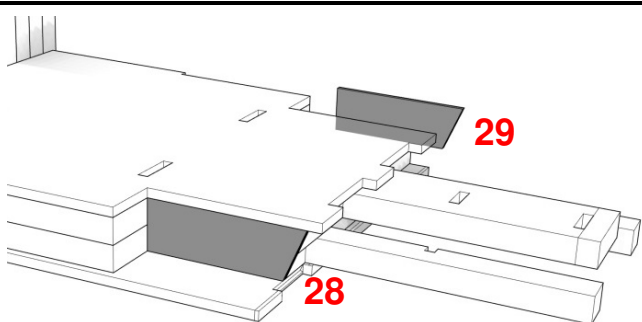

Glue the kick panels 28 and 29 in place.

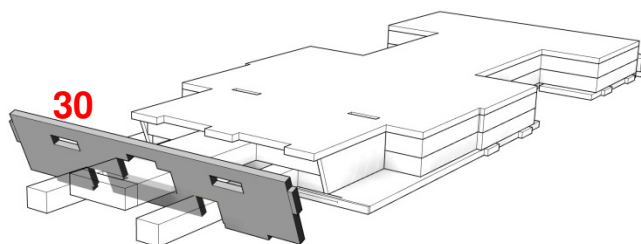

Slide lower firewall 30 through the chassis and glue in place, seated in the tabs and slots both top and bottom.

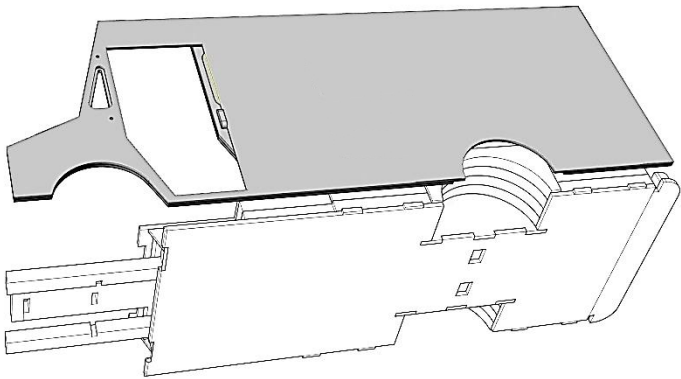

Once satisfied with the fit of the wheel well to the side wall assembly, glue the left wall to the chassis base, seating the slots in the wall with the tabs in the chassis base.

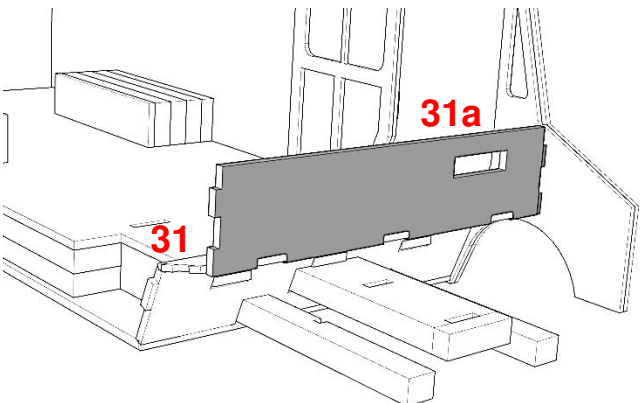

Glue the mid firewall 31 in place. Then glue upper firewall 31a in place.

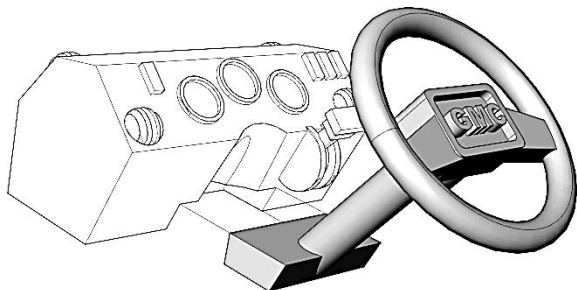

Paint and glue the steering wheel column and driver's console together using CA glue.

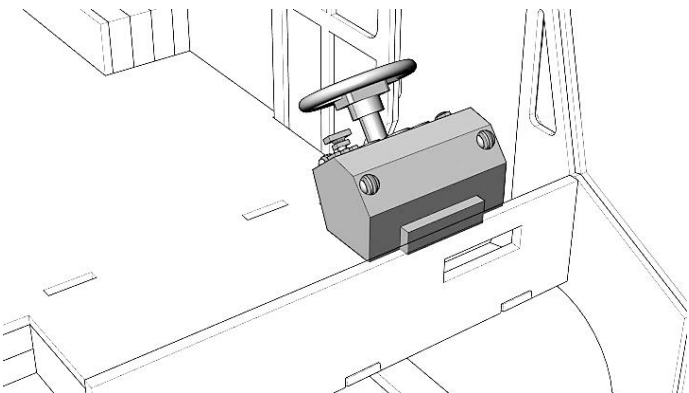

Glue the console to the slot in the firewall.

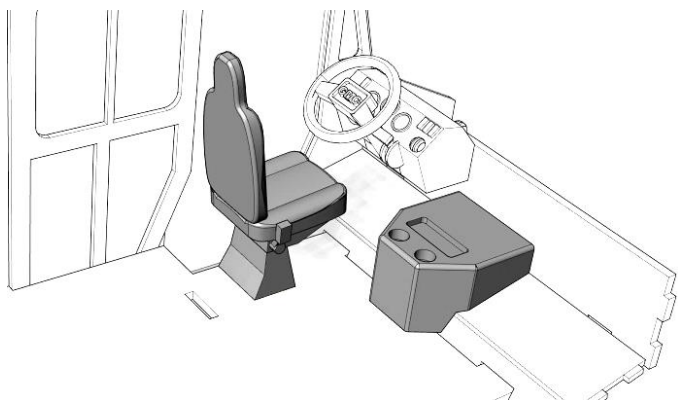

Glue the driver's seat in place flush with the edge of the step in the floor. Glue the engine hump centered with the lower and upper firewall.

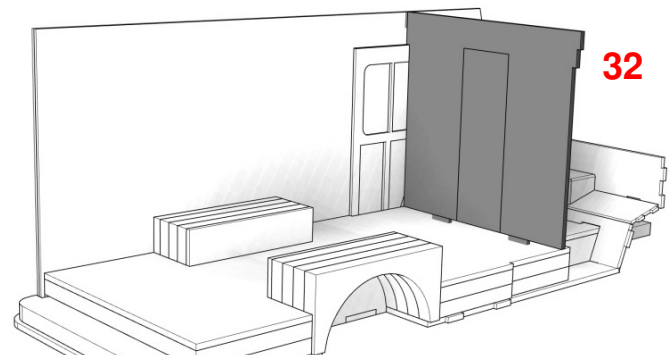

Glue the back cab wall 32 to the floor and top of the driver's side wall.

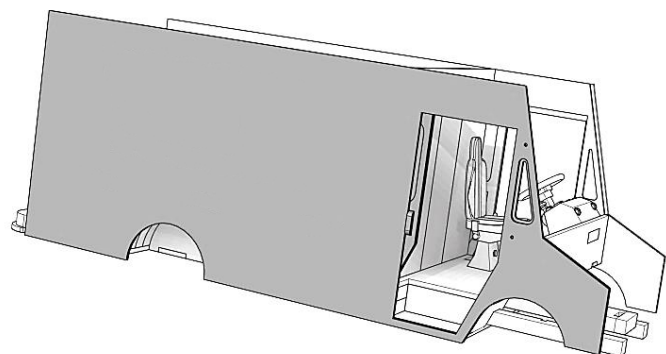

Glue the right hand sidewall assembly in place as you did with the driver's side. Make sure to align the tabs in the firewall and back cab wall.

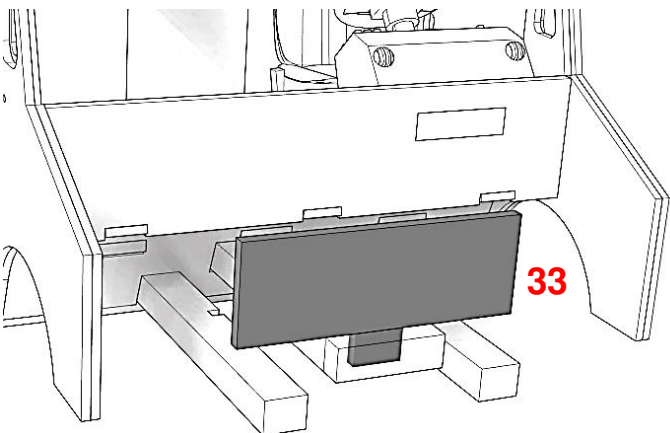

Paint the radiator panel 33 black and drybrush silver. Then glue in place in the slot in the chassis center beam.

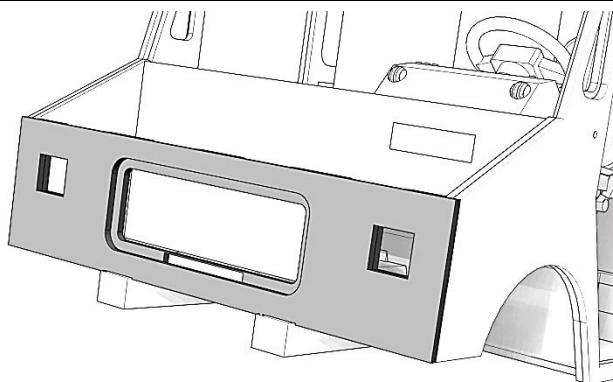

Glue the front engine cowl to the side walls and to the tops of the chassis beam.

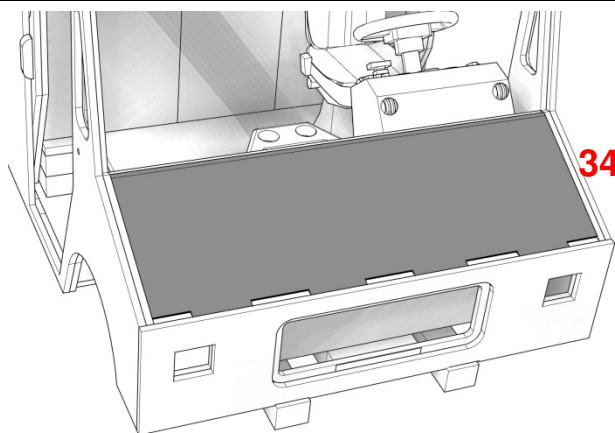

Glue hood doubler 34 in place so it is flush to the front top edges of the sidewalls.

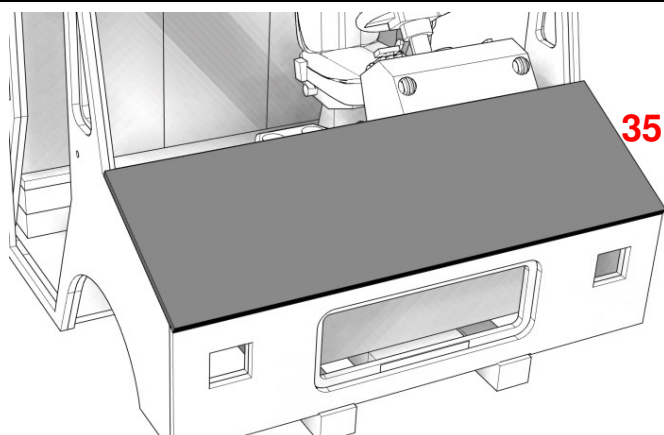

Glue the hood 35 in place.

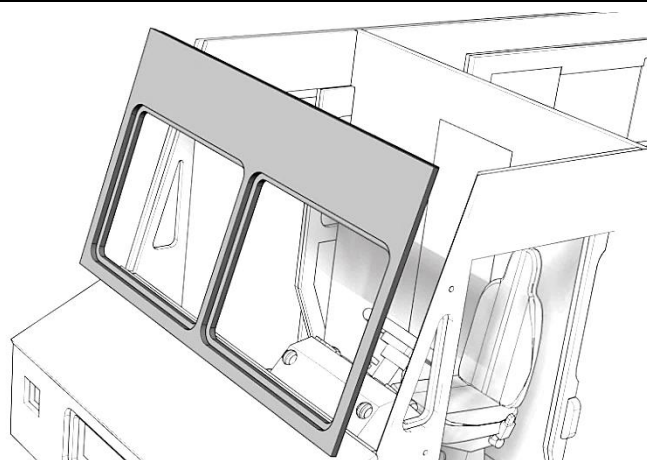

Glue the front windshield assembly in place, fitting in the step in both sidewalls and flush to the top of the body.

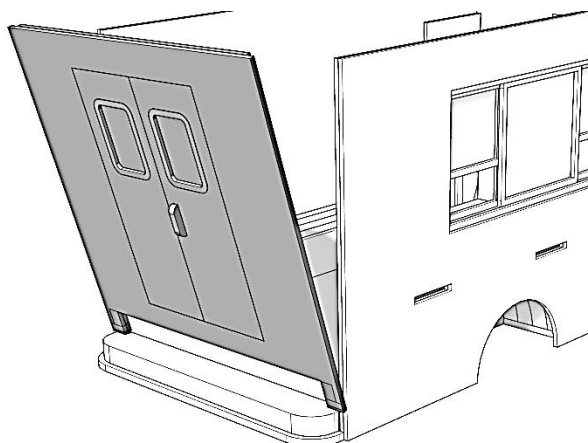

Glue the back wall in place, fitting it to the side walls and to the steps in the back wall assembly.

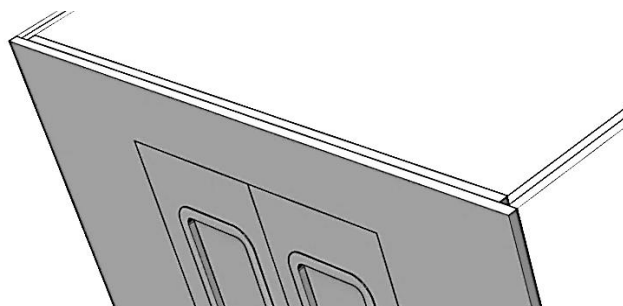

Showing the fit of the back wall.

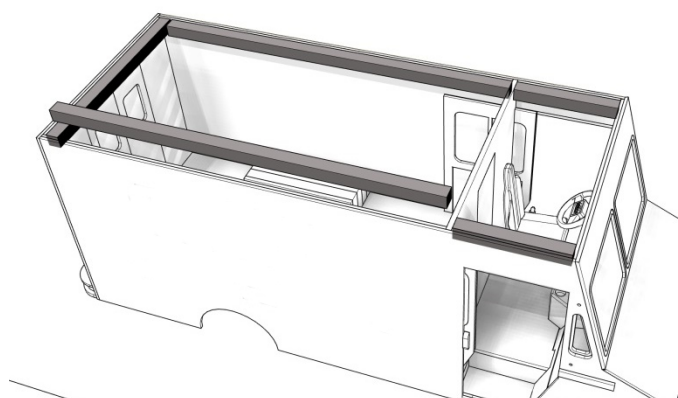

Use the supplied 1/16" square basswood to make bracing for the top of the sidewalls and back wall. Glue in place flush with the top edge of the inner walls. Clamp to keep things straight and square.

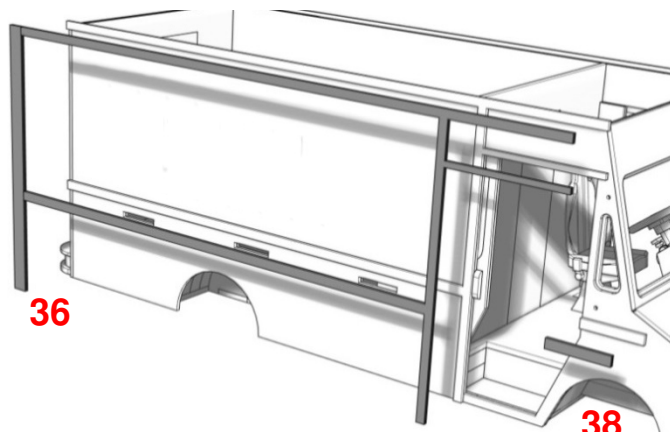

Glue trim detail 36 (shown) and 37 (opposite) in place so that it is flush with the back edge of the side doors and bottom of the body as shown below left. Glue 38 shown and 39 (opposite) in place forward of the side doors.

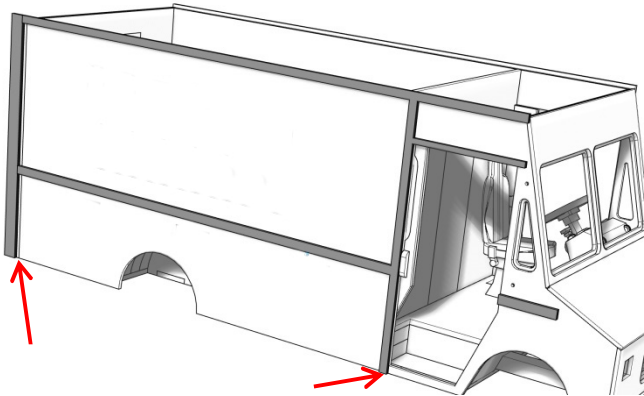

Note that the trim is flush with the bottom of the body and flush to the back edge of the side door and back edge of the side wall.

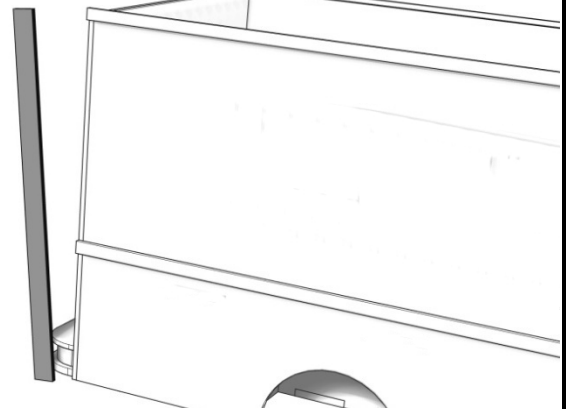

Once the glue is set, remove the carrier tab.

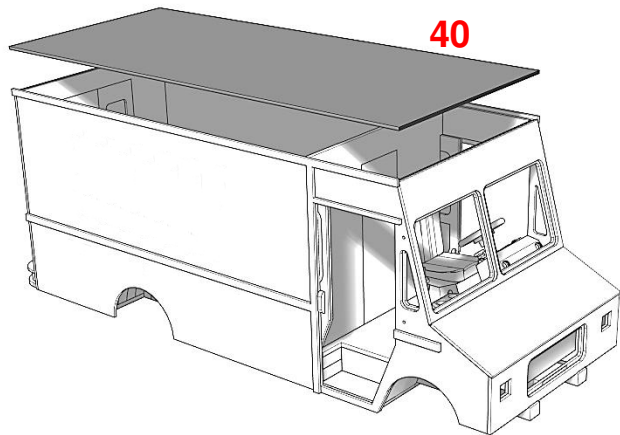

Glue roof panel 40 in place.



Using model or spot putty, fill any gaps in the edges of the body top, sides, front and back. Sand a small radius in these edges to ease the sharp corners and make the body more uniform.

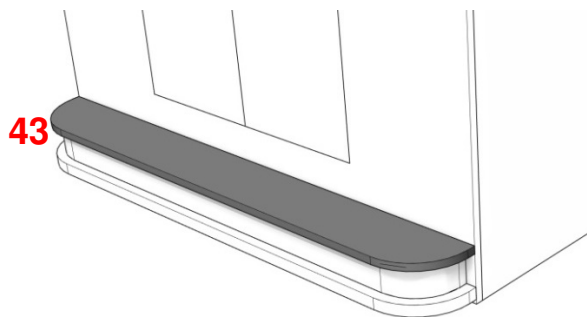

Similarly, paint the rear bumper top 43 as per the vents and glue in place.

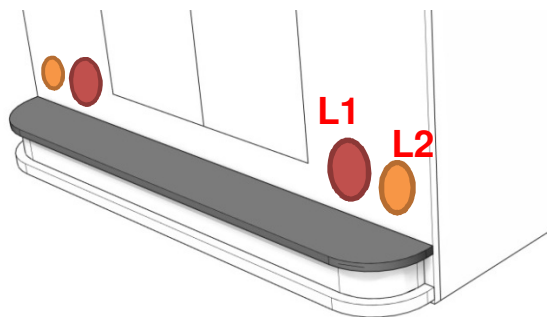

Paint brake and signal lights L1 and L2 and glue in place. Paint a blob of gloss medium over top of the light to form a lens.

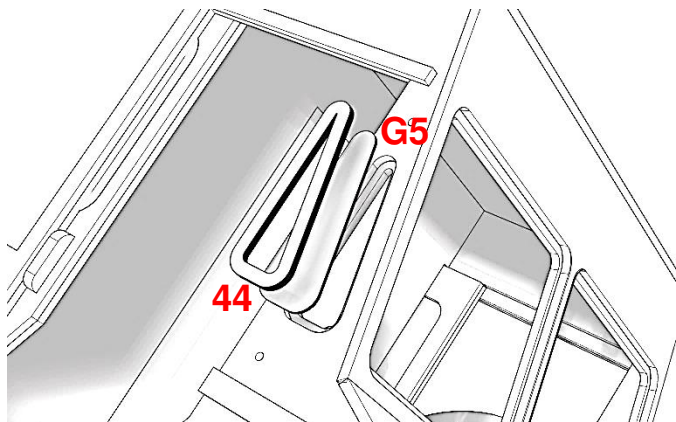

Glue glazing G5 in place. Lightly dab frame 44 in glue and set in place overtop of glazing G5.

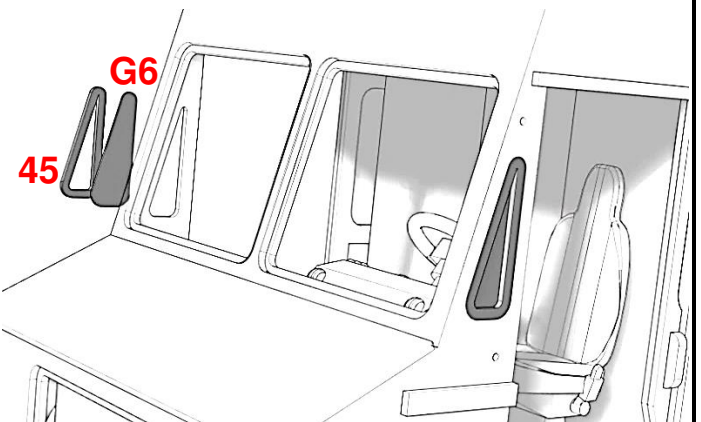

Glue glazing G6 in place. Lightly dab frame 45 in glue and set in place overtop of glazing G5.

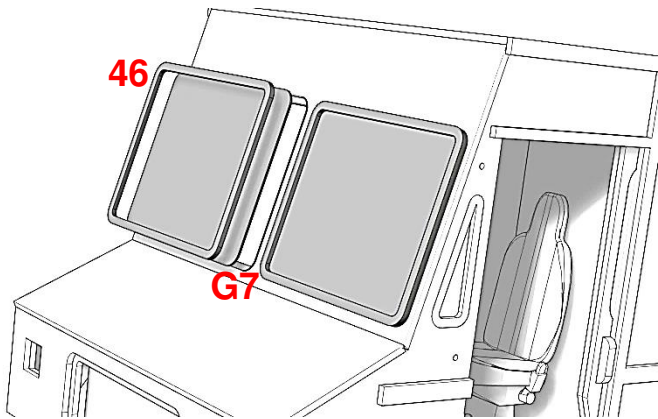

Glue glazing G7 in place on both sides of the windshield. Lightly dab frame 46 in glue and set in place on top of glazing G7. Repeat for the other half of the windshield.

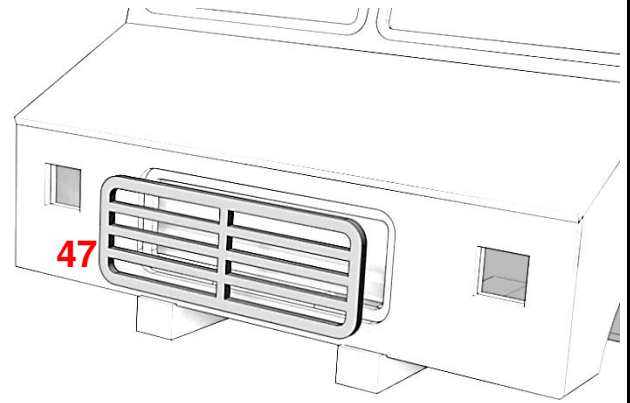

Paint grill 47 silver or black and glue in place. An alternate grill is provided without the center vertical bar.

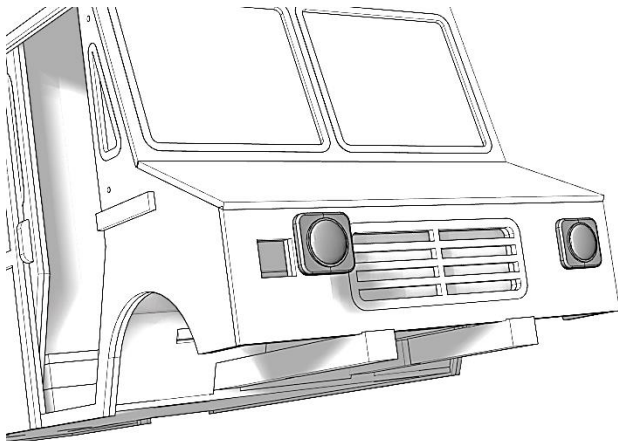

Paint the front lights black and the lens silver and glue into the slots in the cowl front.

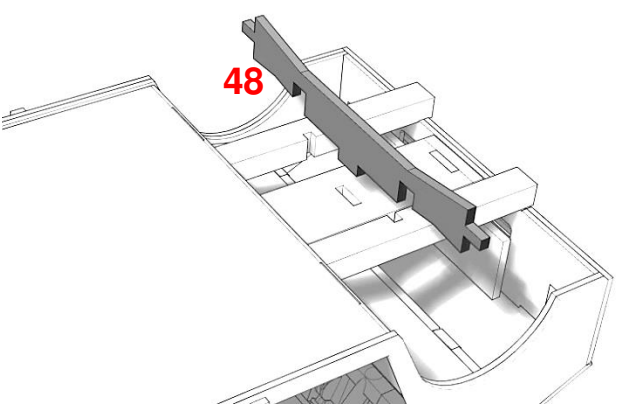

Glue front axle 48 in place to chassis beams.

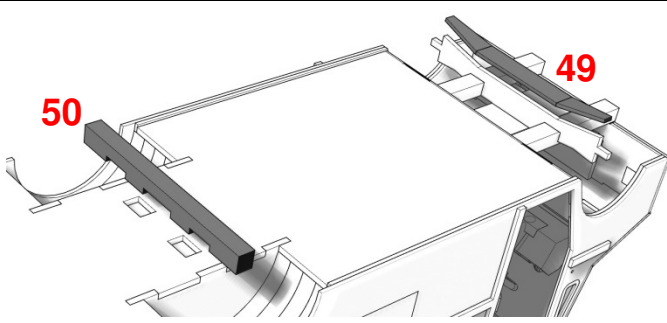

Glue front axle cross frame 49 centered over top of axle 48. Glue rear axle 50 in place into slots in the chassis base.

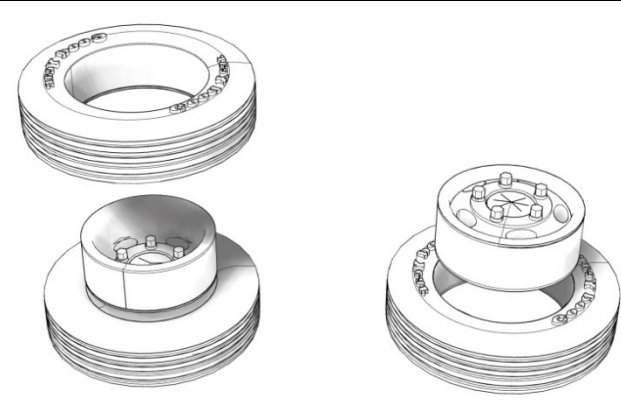

Paint rims white or silver and tires black. Glue and press tires on to rims.

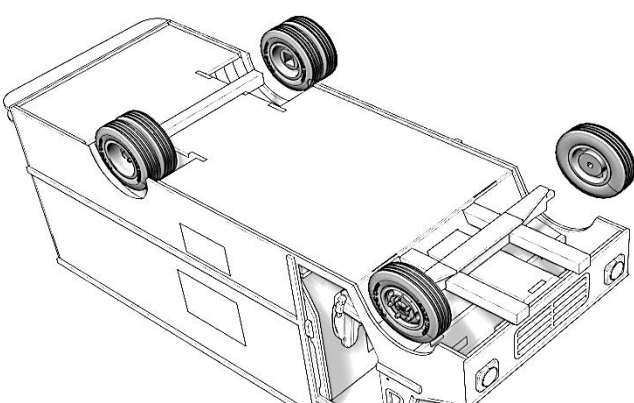

Glue wheels to axles. You might need to adjust the axle diameter to fit the openings in the inside face of the rims.

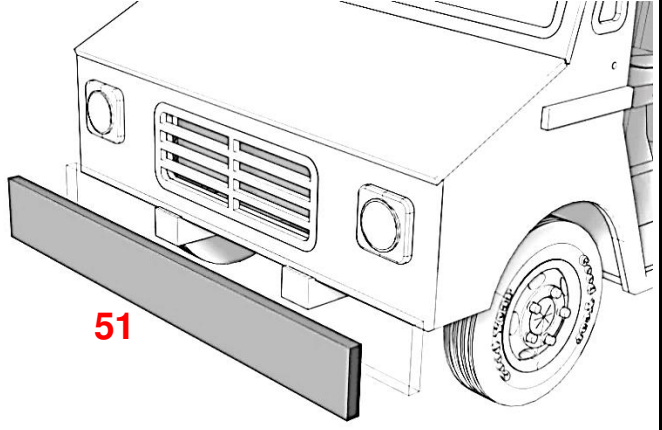

Sand the edges and round the corners of the front bumper. Paint it and glue it in place, centered on the front face of the chassis beams.

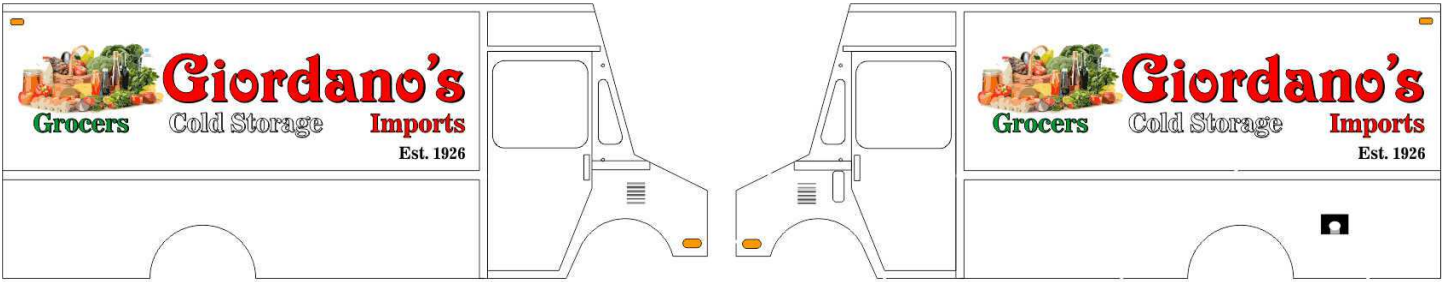

Cut out each waterslide decal as close as possible to the edge of the printed portion. Soak in warm water for about 30 seconds until the decal is loose from the carrier paper. Place the decal where you want it. Slide the carrier paper out from under the decal and blot the decal in place, removing any wrinkles. I like to coat the dried decal areas with flat clear paint, thinned matte medium or Mod Podge to protect the decal and feather the hard decal edge.



Use the mirror frame bending template to bend and trim the supplied 0.0125 bronze wire to size. Glue the wire into the holes in the body sides. Glue the mirrors 55 and 56 to the wires at approximately a 45 degree angle.

